

中国建材通讯

CHINA BUILDING MATERIALS MAGAZINE

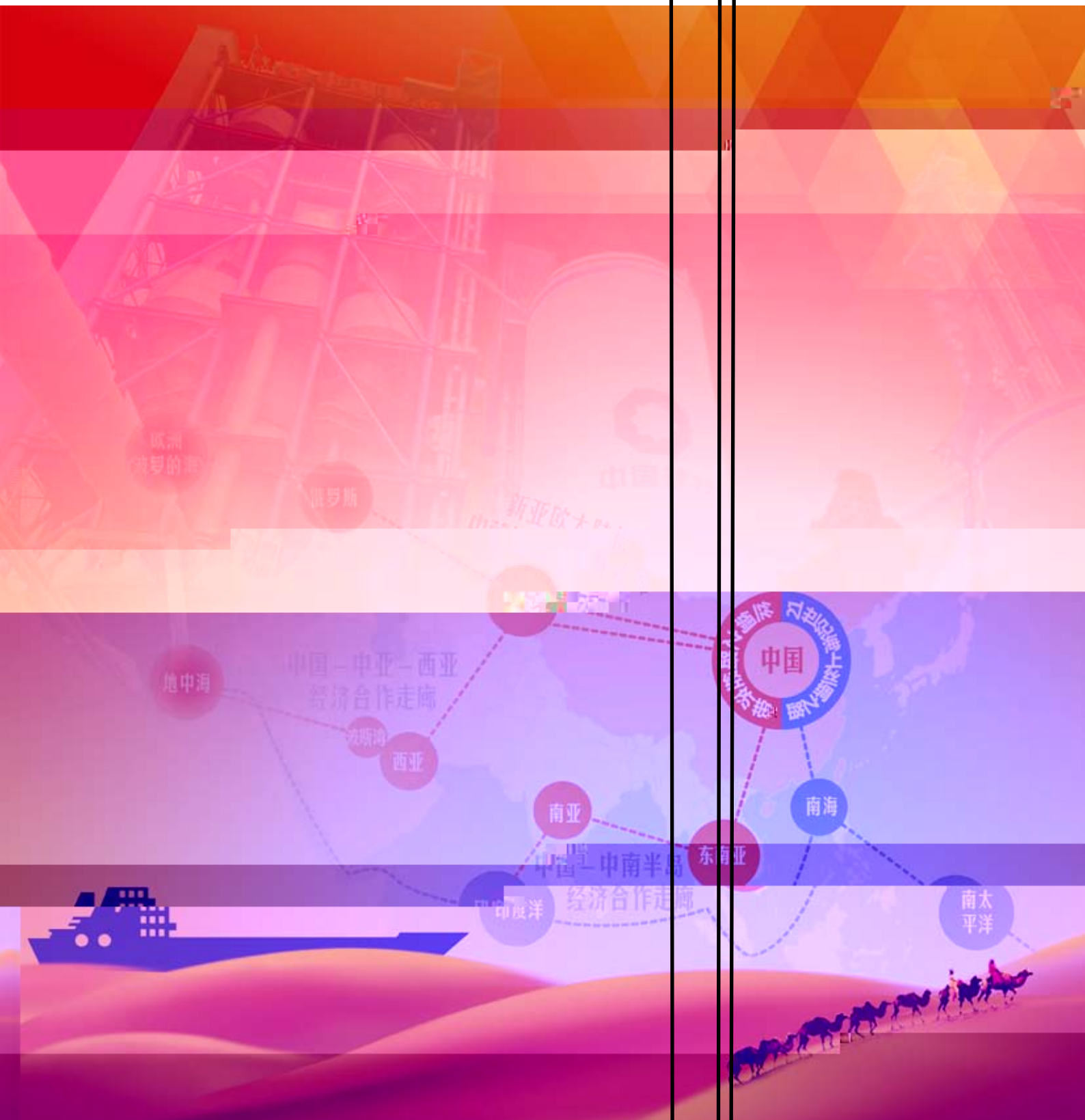



News in pictures

- 1. 4 17 2015
- 2. 4 21 " "
- 3. 4 28
- 4. 4 27

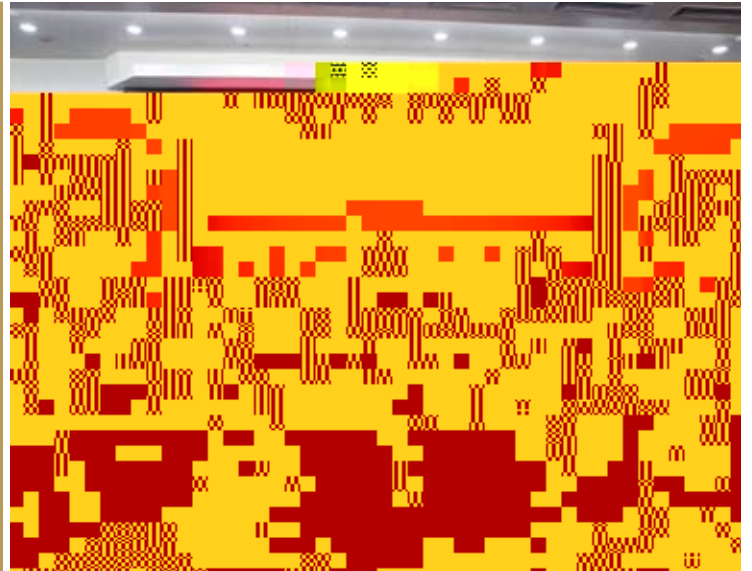

25 5% 2013 8-10 96% 2014 1.8% 24
3.4% 1.6%

“ ” “ ”

32.5

C12+3

780

70% 80% 2008 16% 52%

“ ” “ ” “ ” “ ” “ ” “ ”

1

4

5

50

6

2015

7

8

UCC

104

9

10

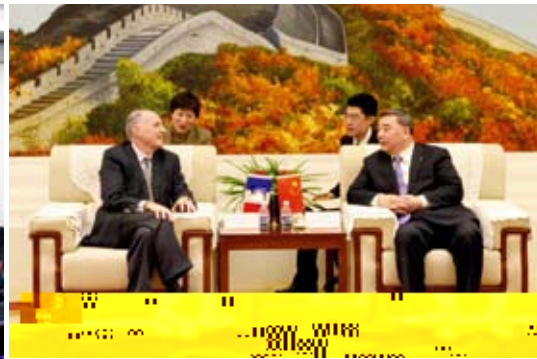

24

27

32

37

39

42

46

49

51

54

55

燚

13

2015

7

4 15



4 10 2015
50
5 6

2014 500

+ =

2014
131 13% 103
17%

50

11

2015

4 9

2015

70

æ

2014





3 2 4 30

48

20

48



3 31 21:00

3 31

UCC

104

UCC

100

7

UCC

3 29



4 10

60

2015

2015



5

2015

2015

5



//

//

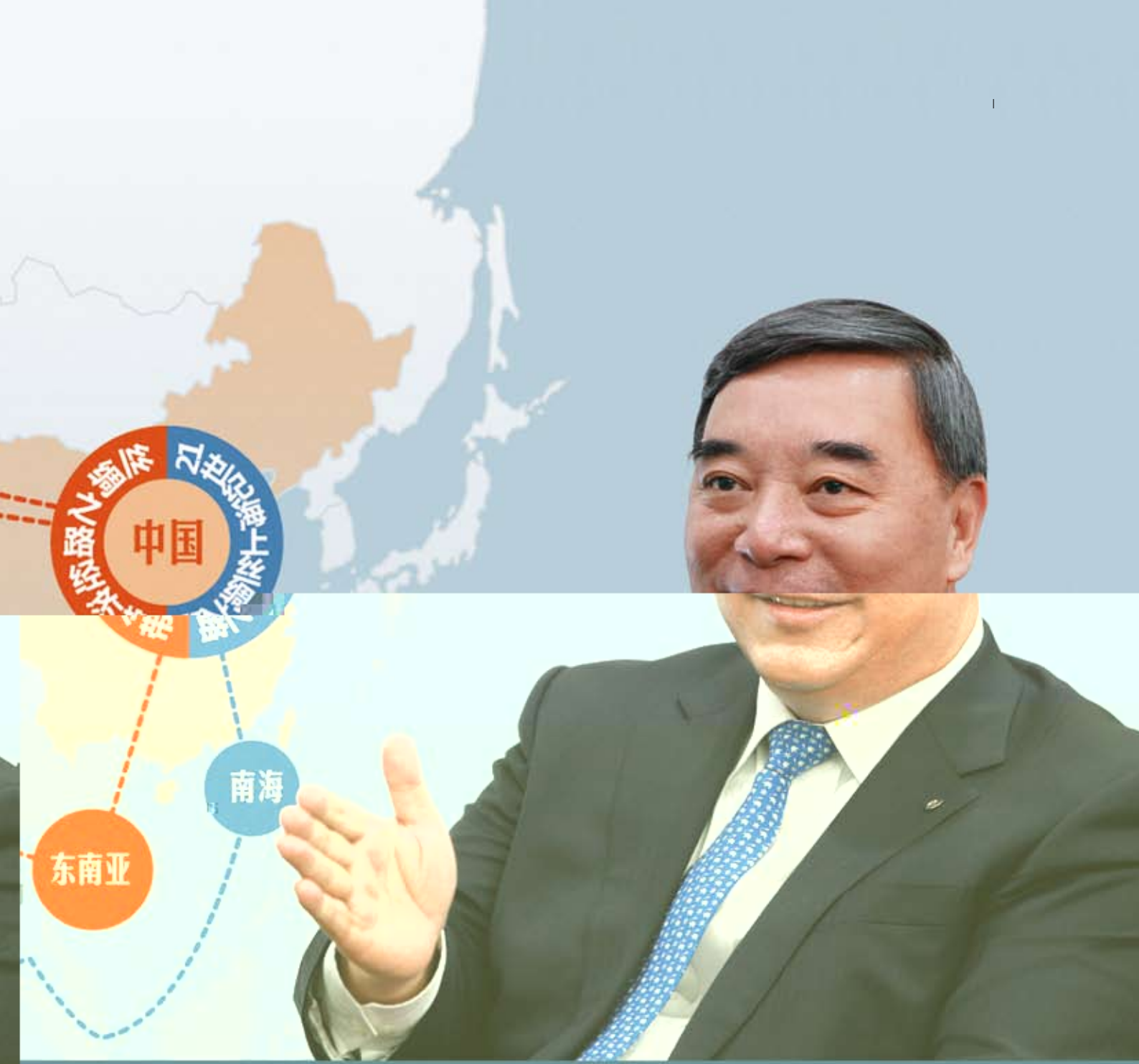

//

//

//

//

链接

2013

“ ” “ 21 ” “ ”

70%

20

30

30
3

60

44

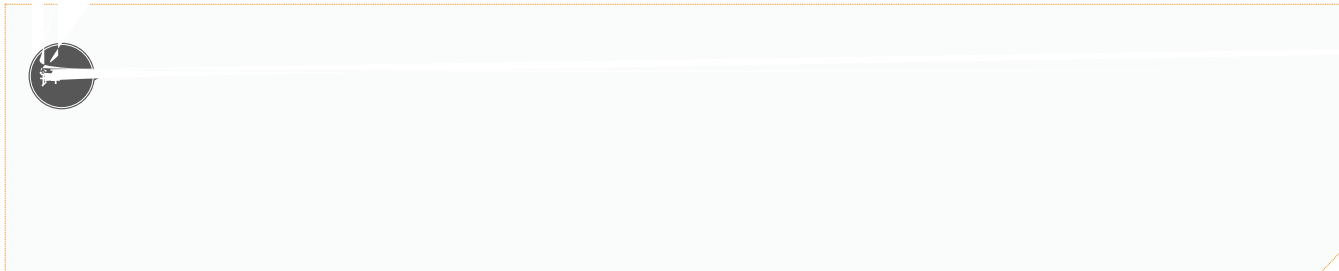

“

”

“

”

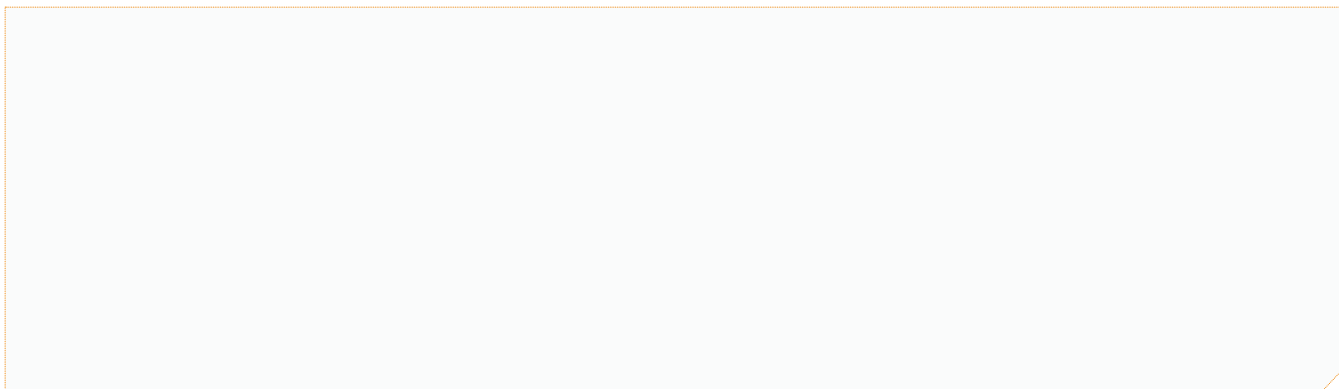



//

//

//

//



“ ”

EPC EP
70 30

“ ”

30

链接

“ ”

“ ”

“ ”

13

10

4200

1

3



2500 12000
5000
4.0
100

3.2

300 1200
0.2

1.3mm STN

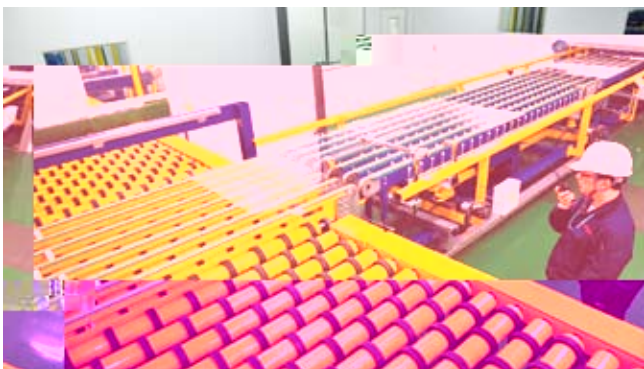

10%

10

E6

E7





8

2500

链接

20%
10% 90%

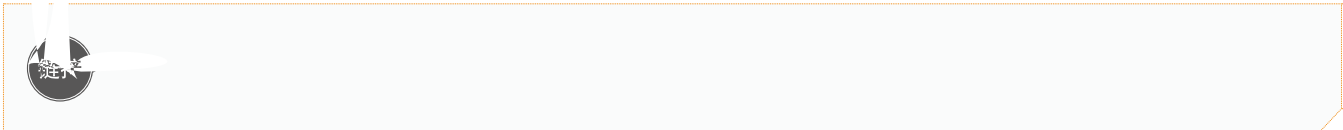

EPC





MBA

2012 2013
2012 11

OK

15 2013 7
500
2013

1997

3

30

30

30

5

IBM

IBM

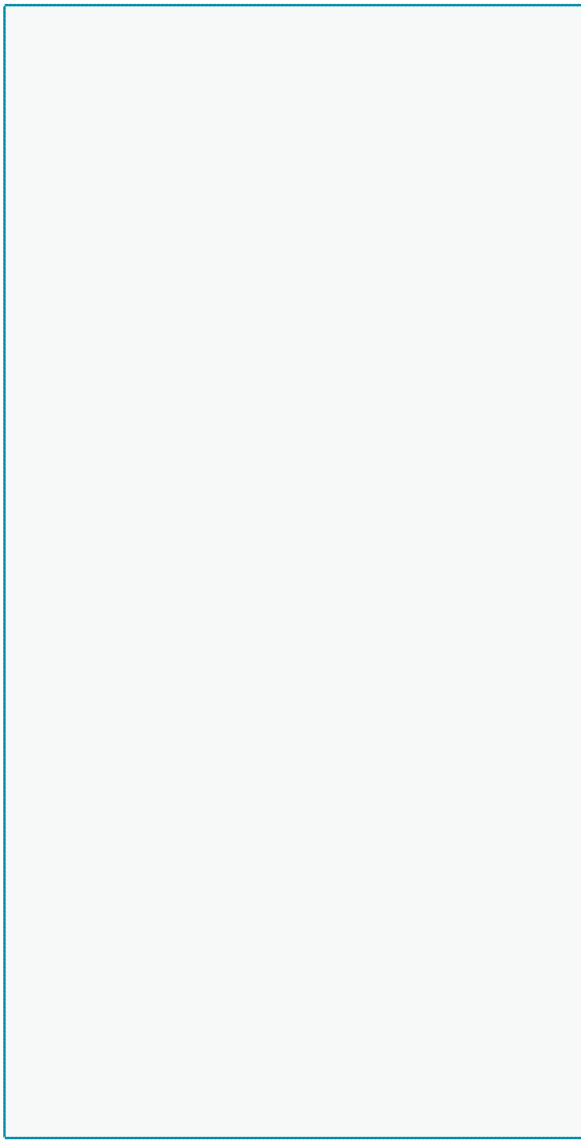

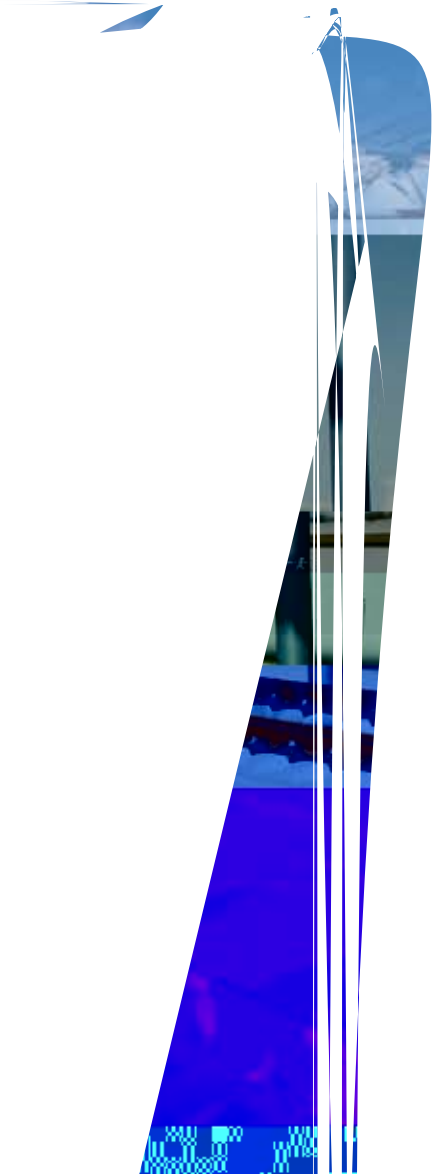

2000
169
20 80
1981
IECEE
1990 9
CB
IECO
IECEE



ISO 9000
ISO 14000

ISO 9001

ISO 14000

CTC

3C



6 13
 14
1400

E t

LBNL

LBNL

3
CTC

6
IGDB

11

4
CTC

5 2/ CTC

CTC

CTC

C

JC/T 2 -2
EVA

2/ / CTC

CTC

2/ /

CTC

CTC

TC

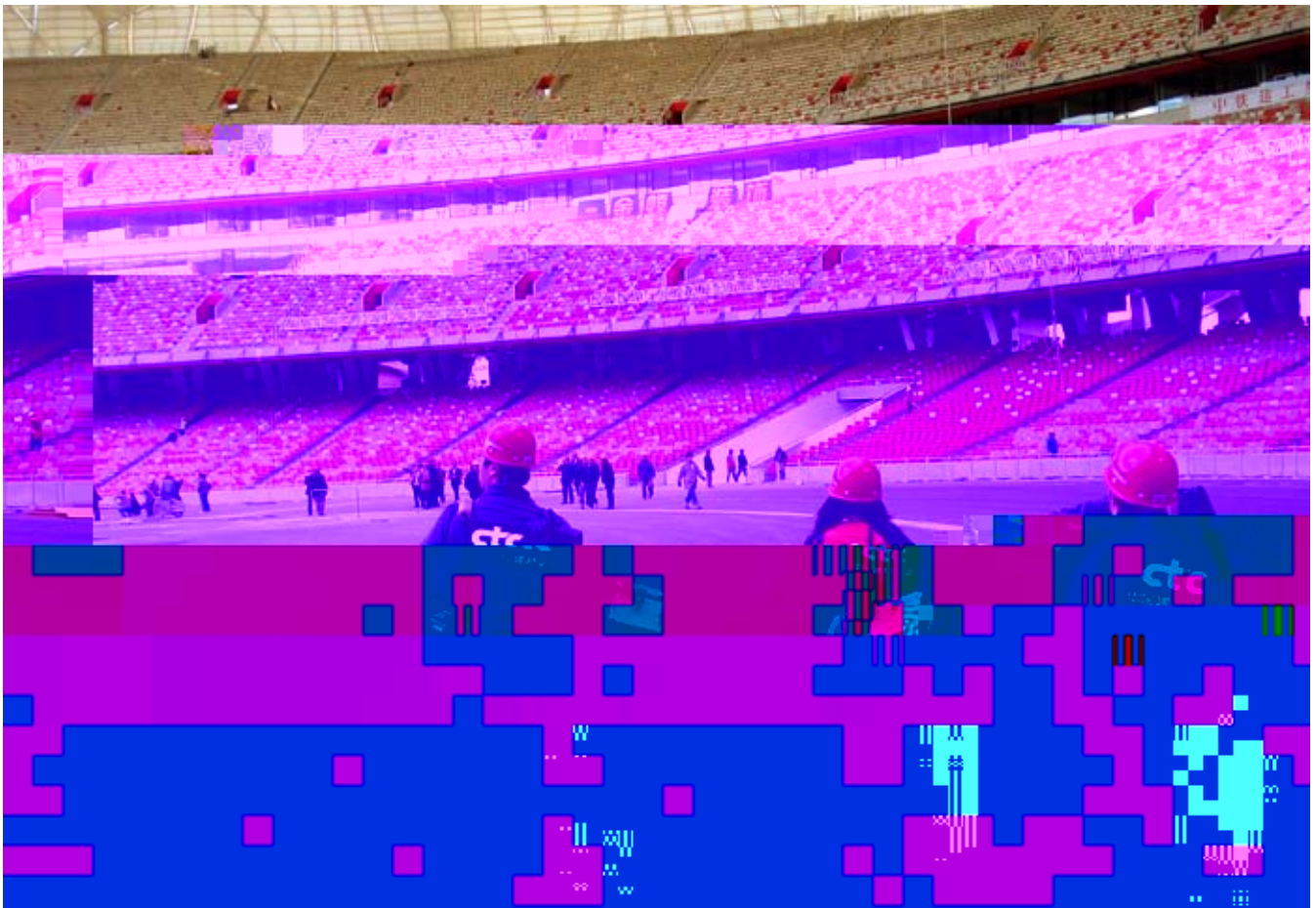

3M 300
CTC 3 /

CTC
CTC

1
CTC /

2002 CTC

11 /

2008

CTC

29 CTC

CTC CTC

2
CTC

CTC

/

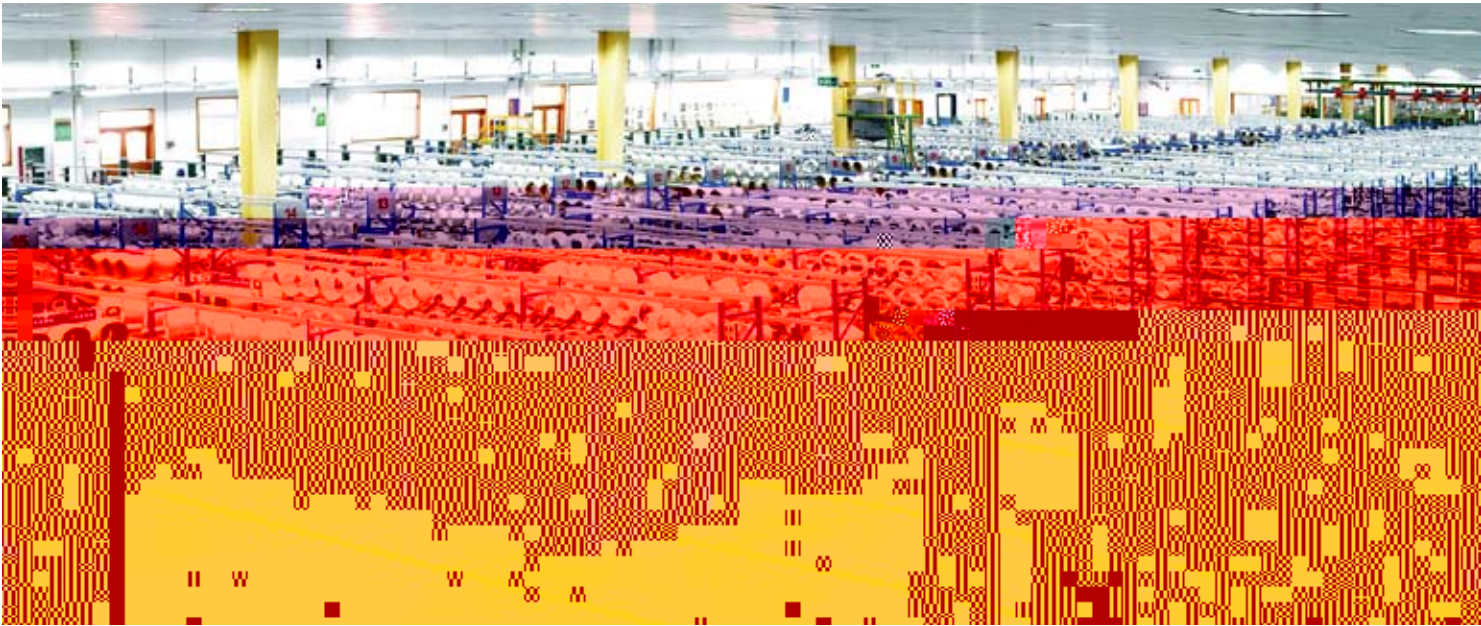

“

”

1993

16

20

100

14

2008

1998

2008



P A

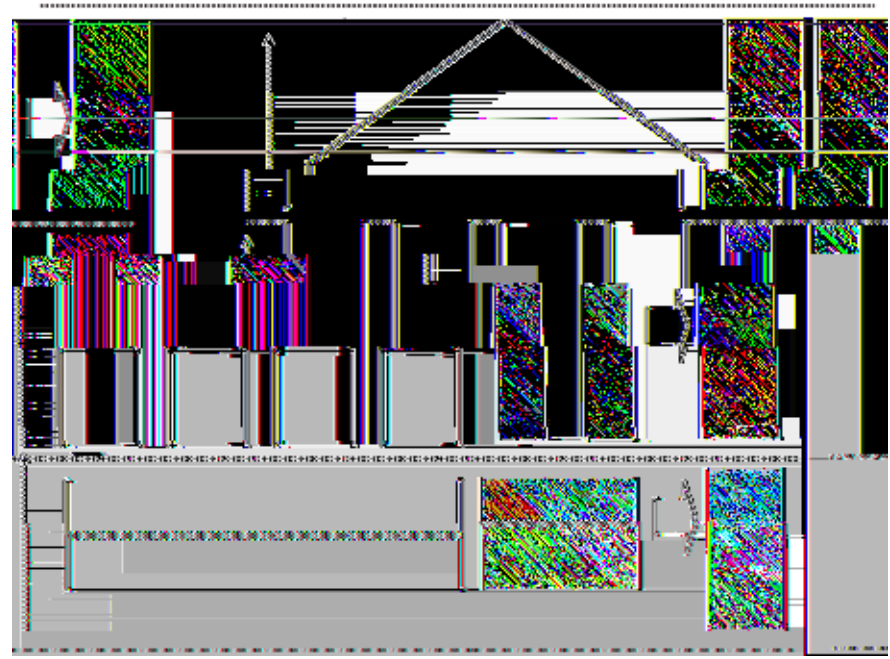



2009 30.29
48.56
18770.28
99757.80

2013
2009
2013



3

2008

2.

1

1.

2

100%

3

44 31
2013
49%

“

”

2015	3	20	A
		2014	
		2014	
83		10.8	
16.6		15.5%	
14.7		16.8%	



2004-	2013
	30%
	2013

2003	21	19.3	12.9
------	----	------	------

4500

16.5

20

54

17.8

90

2010

43

T3

500

90%

(

) 2014

APEC



2014

1921 1949

1921

1935

1935 1949

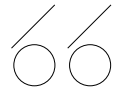

1949 1978

1956

1956 1978



1978 12 1992

1992 10

μ



3 31

104

UCC

UCC Unite Cement Company

90

Alesayi

1.07

13

2008 8

2010 3

400

2011 3

2012 12

2013 2

120%



2014 9

24

10

3 19 3 25

1

UCC

90

2 23

3 25



UCC

25

104

7

3



3 25

29

2 40

99

4

5

104

5 40

Concert

3 29

11

104

5

3 26

3 27

28

3 28

104

122
29 2 40

8 104
10 30



4 45
ET604

31

104



3 31 8 10
104

T3

9 40

3 31

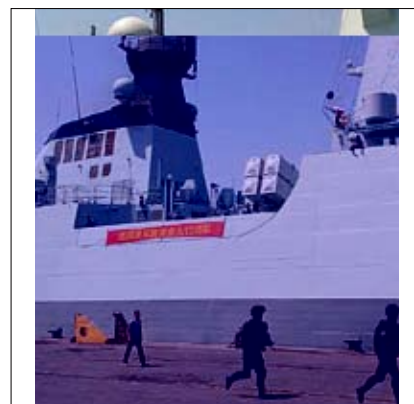

104

40

30

KPI

660
4000
220

CR10
2008 16% 2014 53%

2025



+

TFT



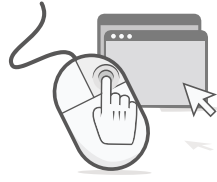

01

4 20

02

03



05



0.2

06

Raventhorpe Farm 39.3

TATA Steel

04

2015

500

24

500

500

1600

910.64

2015

500

500

07

4 9

08

4 8

09

Best- Group NS

5

10

3200
3200

11

4 1

10000

12



4 15

117

B2B

13

4 3

+



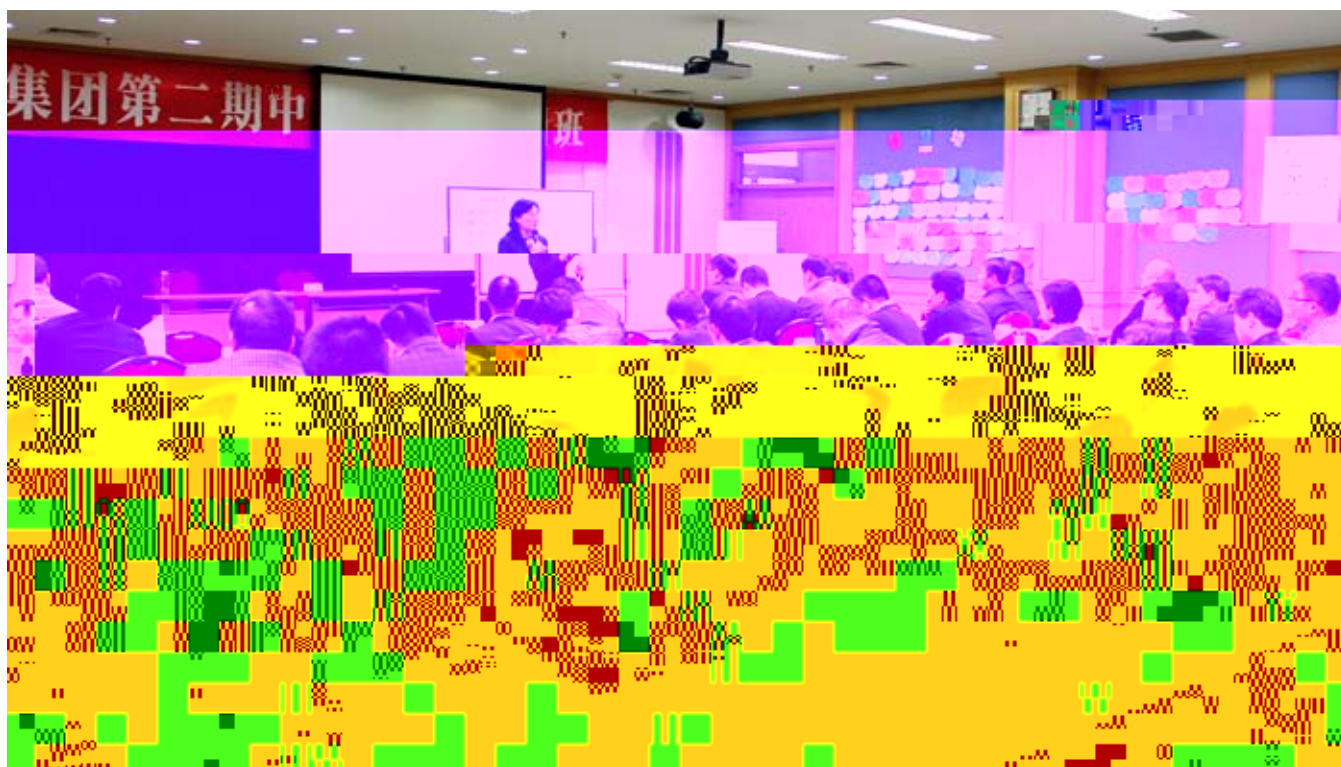

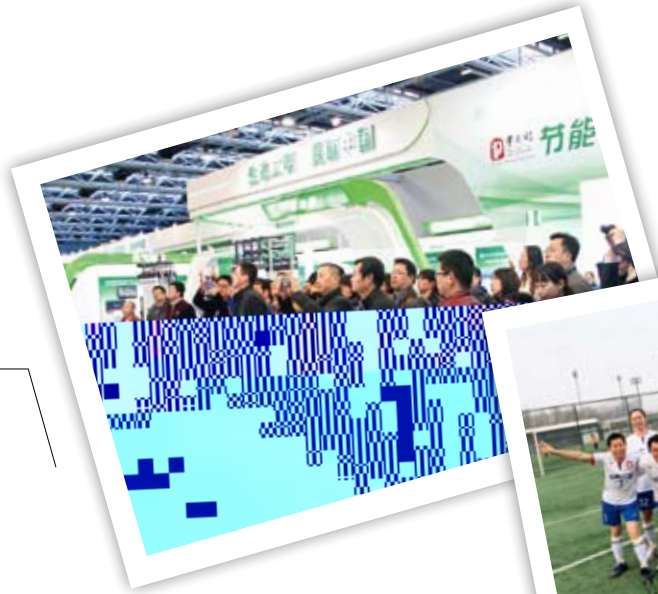

LOGO

安全生产

